



महाराष्ट्र मेट्रो रेल कॉर्पोरेशन लिमिटेड
MAHARASHTRA METRO RAIL CORPORATION LIMITED
भारत सरकार आणि महाराष्ट्र शासनाचा संयुक्त उपक्रम
Joint Venture of Govt. of India & Govt. of Maharashtra
PUNE METRO RAIL PROJECT

MAHA-METRO/PMRP/P&C/QUOT/2024/Dec/ 3314

Date: 09-Dec-2024

QUOTATION NOTICE

Sealed Quotations are invited on behalf of Maha-Metro for the work of "Supply & Installation of 01 No. 3-phase squirrel cage induction motor (Make-Crompton Greaves) for EOT crane in Range Hill Depot of Pune Metro Rail Project" from interested bidders, having prior experience in carrying out similar works.

Quotation No: MAHA-METRO/PMRP/P&C/QUOT/2024/Dec/01

Completion Period: 15 days from the date of issuance of LOA/Work Order.

Instructions:

1. 'Quotation Form' (08 Pages) may be obtained from the office of Pune Metro Rail Project, Block No. A2, Food Grain Godown, Near Civil Court, Next to Kamgar Putala Vasahat, Shivajinagar, Pune-411005 or may be downloaded from Pune Metro Rail Project's official website 'www.punemetrorail.org' under 'Tender' Section from 17:30 Hrs. of 09-Dec-2024 onwards. The 'Quotation Form' is also attached herewith for reference.
2. Duly Filled, Stamped, Signed and Sealed Quotation Forms (in Hard Copy only) shall be submitted by interested bidders, in the office of Executive Director/Procurement & Contracts, Pune Metro Rail Project, Block No. A2, Food Grain Godown, Near Civil Court, Next to Kamgar Putala Vasahat, Shivajinagar, Pune-411005, till 16:00 Hrs. on 19-Dec-2024.
3. Quotation submitted by e-mail (or) any other mode shall not be accepted.

4.12.24
Executive Director,
Procurement & Contracts, Pune Metro Rail Project
For and on Behalf of Maharashtra Metro Rail Corporation Ltd.

Copy to:

1. Notice Boards, Pune Metro Rail Project Offices
2. Office File



महाराष्ट्र मेट्रो रेल कॉर्पोरेशन लिमिटेड
MAHARASHTRA METRO RAIL CORPORATION LIMITED
भारत सरकार आणि महाराष्ट्र शासनाचा संयुक्त उपक्रम
Joint Venture of Govt. of India & Govt. of Maharashtra
PUNE METRO RAIL PROJECT

QUOTATION FORM

Quotation No: MAHA-METRO/PMRP/P&C/QUOT/2024/Dec/01

Date: 09-Dec-2024

Name of Work: Procurement of 01 No. 3-phase squirrel cage induction motor (Make-Crompton Greaves) for EOT crane in Range Hill Depot of Pune Metro Rail Project.

1. Name of Bidder: _____
2. Address of Bidder's Registered Office: _____

3. Name of Bidder's Authorized Signatory: _____
4. Email-ID & Contact no. of Bidder's Authorized Signatory: _____

5. Date of Issue of Quotation Form: 09-Dec-2024
6. Last Date & Time of Submission: Till 16:00 Hrs.on 19-Dec -2024
7. Quotation Opening Date & Time: 16:30 Hrs on 19-Dec-2024
8. Place of Submission: Office of Executive Director/Procurement & Contracts, Pune Metro Rail Project, Block No. A2, Food Grain Godown, Near Civil Court, Next to Kamgar Putala Vasahat, Shivajinagar, Pune-411005.
9. Assigned Time period for Completion of Work: 15 Days from the date of issuance of LOA/Work Order.
10. Scope of Work: Supply & Installation of 1 no. 3-Phase squirrel cage Induction motor (refer Annexure B for specifications required) of EOT crane in RBL-1, IWB building, Rangehill depot, PMRP, Shivajinagar, Pune-411005.
Please refer Annexure B: data sheet for 3 phase induction motor. Any deviation from Annexure B will not be accepted.



Stamp & Signature of Bidder's Authorized Signatory	
--	--

11. Bill of Quantity (BOQ) / Financial Offer:

Sr. No.	Description of work/activities	Unit	Rate in INR (Excl. GST)
1	Supply & Installation of 3-Phase squirrel cage induction motor of (Make-Crompton Greaves) in EOT crane. (Technical Specification Enclosed)	01 Nos	INR
2	GST Amount (18 %)		INR
3	Total Amount of work incl. GST		INR

12. Instructions regarding submission of Quotation Form:

a. The Bidder shall submit his offer along with prescribed formats enclosed as:

Annexure-A: Format for Firm /Agency details

The offer shall be submitted along with the copies of Company Incorporation certificate/Statutory Registration certificate (like Shop Act Certificate etc.), Goods & Service Tax (GST) registration certificate, PAN card, Original Cancelled Cheque/Copy of Cancelled Cheque/Bank Mandate Form, Authorization letter in the name of the person authorized for Signing and submission of quotation on company letter head.

- b. All pages/formats & documents provided by bidder must be duly stamped & signed by authorized signatory of the Bidder.
- c. Overwriting on the rates quoted shall not be accepted.
- d. Any modification/ correction/ replacement in offer after opening time & date shall not be permitted.
- e. Any condition(s) incorporated by bidder other than above, shall result in outright rejection of the offer/ proposal.
- f. Any conditions, deviations, assumptions, exclusions, suggestions of alternative clauses, request of amendments in conditions & specifications of work or any other information submitted by you along with the Quotation Form, which is different from the Quotation Form & Quotation Notice



Stamp & Signature of Bidder's Authorized Signatory	
--	--



महाराष्ट्र मेट्रो रेल कॉर्पोरेशन लिमिटेड
MAHARASHTRA METRO RAIL CORPORATION LIMITED
भाजन सरकार आणि महाराष्ट्र शासनाचा संयुक्त उपक्रम
Joint Venture of Govt. of India & Govt. of Maharashtra
PUNE METRO RAIL PROJECT

issued by Maha-Metro or its representatives, shall not be treated as a part of the LOA/Work Order and shall not be binding upon Maha-Metro in anyway whatsoever at any stage of work during execution or thereafter, unless specifically agreed to by Maha-Metro in writing.

13. Evaluation Criteria:

The submitted bids shall be opened on scheduled date & time, by an authorized Opening Committee. Bidder having experience of subject work shall be considered for technical evaluation. Bidder shall submit work completion certificates of similar works having experience in supply & installation of 3 phase squirrel cage induction motor of 2 years from the last date of submission of bid. The Annexure B must be signed off by bidder as an acceptance of technical specifications. Any deviation from Annexure B will not be accepted. Based on technically qualified bidder & total cost quoted by eligible bidders shall be compared. A comparative statement shall be prepared by the committee & the technically eligible bidder who has quoted the least cost (Gross Total of the BOQ) shall be declared as L-1 bidder & may be considered for award of the work.

14. Payment Terms, Key Dates and Work Milestones:

- 100% payment on completion of subject work. Payment will be done within 30 days from the date of submission of certified bill by official of Maha-Metro to the Finance department.
- No advance payment will be made.
- No interest/compensation shall be paid due to any delay due to unforeseen reasons or whatsoever.
- Payment shall be made to the bidder in INR only, and through electronic means: RTGS, NEFT or Net banking only.
- Maha-Metro shall deduct the tax at source (TDS) from the payments to the Bidder which will be required by law for deposition with the statutory authorities in India for which TDS certificates will be issued by Maha-Metro.
- The payment of all applicable taxes & duties excluding GST and any other charges shall be in scope of the bidder and the quoted price shall be inclusive of these taxes & duties. The Bidder shall provide break up of taxes and duties in its invoices. Any variation in statutory taxes and duties will be borne both ways i.e. in case of increase in taxes and duties, Maha-Metro will bear the additional amount and in case of decrease in taxes and duties, Maha-Metro will be reimbursed the difference amount.



Stamp & Signature of Bidder's Authorized Signatory	
--	--

15. Liquidated Damages (LD)

The work shall be strictly completed as per the timeline given above. LD shall be imposed at a rate of 0.2% of the accepted LOA/Work Order amount for each day of delay after the completion period subject to a maximum of 10% of accepted LOA/work order amount.

16. Penalty

In case the execution of work is not found to be satisfactory, proportionate deduction from Bidder's Bill shall be made and the LOA/Work Order can be terminated by Maha-Metro after giving a Notice of Seven (07) days to the Bidder. In case of such termination, the Performance security deposit shall be forfeited by Maha-Metro.

17. Termination:

Maha-Metro reserves the right to terminate the LOA/Work Order at any time without assigning any reasons, after giving a notice of Seven (07) days.

18. Extension of time: Suitable extension may be granted for delay due to unforeseen reasons, if certified by Maha-Metro.

19. Variation:

- The LOA/Work Order shall be awarded on fixed rate basis for the entire work period. No request for escalation in rates shall be entertained on account of any reasons during the work period or its further extension due to unforeseen reasons.
- The Employer at its discretion, may reduce/delete items as specified in scope of work depending upon requirement & other factors. Any addition in the scope of work shall be payable at the mutually agreed rates & amounts.

20. Performance Security Deposit:

Performance Security Deposit @10% of the Accepted LOA/Work order amount shall be deposited through NEFT/RTGS/Internet Banking in the account of Maharashtra Metro Rail Corporation Ltd.



Stamp & Signature of Bidder's Authorized Signatory	
--	--



महाराष्ट्र मेट्रो रेल कॉर्पोरेशन लिमिटेड

MAHARASHTRA METRO RAIL CORPORATION LIMITED

भारत सरकार आणि महाराष्ट्र शासनाचा संयुक्त उपक्रम
 Joint Venture of Govt. of India & Govt. of Maharashtra
 PUNE METRO RAIL PROJECT

within 10 days from the date of issue of LOA/Work order. The Performance Security Deposit shall be returned after expiry of DLP/Warranty period of 12 months.

21. The Bidding Process & LOA/Work Order shall be governed by, and construed in accordance with, the Laws of Govt. of India & Govt. of Maharashtra and the Courts at Pune & High Court of Bombay shall have exclusive jurisdiction over all disputes arising under, pursuant to and/or in connection with the Bidding Process & LOA/Work Order.

22. Essential Enclosures:

- a. Copy of Company Incorporation Certificate/Statutory Registration Certificate (like Shop Act Certificate etc.)
- b. Copy of PAN Card
- c. Copy of GST Registration Certificate
- d. Original Cancelled Cheque/Copy of Cancelled Cheque/Bank Mandate Form



Stamp & Signature of Bidder's Authorized Signatory	
--	--



महाराष्ट्र मेट्रो रेल कॉर्पोरेशन लिमिटेड

MAHARASHTRA METRO RAIL CORPORATION LIMITED

भारत सरकार आणि महाराष्ट्र शासनाचा संयुक्त उपक्रम
Joint Venture of Govt. of India & Govt. of Maharashtra
PUNE METRO RAIL PROJECT

Annexure-A

Format for Firm/Agency Details

SN	Description
1.	Name of the Firm/Agency:
2.	Address with Telephone, Email, Fax Numbers & name(s) of the Contact person
3.	Year of Establishment (Please attach shop Act Certificate/certificate of incorporation etc):
4.	Income Tax-PAN No. (Please attach PAN Card):
5.	GST No. (Please attach GST certificate):
6.	Bank Details:
7.	Verifications: The authorized person shall sign all the documents on the bottom right-hand side. Documents without signatures shall not be considered for evaluation purpose & the bidder may be disqualified on this account.



Stamp & Signature of Bidder's Authorized Signatory	
--	--

CG Power and Industrial Solutions Limited

 LT Motors Division
 Ahmednagar

DATA SHEET OF 3 PHASE INDUCTION MOTOR

Customer : Enquiry / INDENT NO : NMCD220697/100 (Dated: 08/27/2024)

Frame	ND100L	Rated Output (kW)	3.7
Voltage (V)	415 +-10%	Rated Current (A)	8.25
Rated Speed (RPM)	1440	No of poles	4
Frequency (Hz)	50 +-5%	Duty	S4,40% CDF, 150
Method of Cooling	IC411	Degree of Protection	IP55
Gas Group	Not applicable	Mounting	B3
Temp Class	NA		
Enclosure	TEFC Safe Area		
Load	100% Load	75% Load	50% Load
Efficiency	78 %	75 %	69 %
Power factor	0.80	0.76	0.68
AMB. Temp/Temp rise	50°C/70°C (By Resistance Method)		
Insulation class	F (Temp. rise limited to class 'B')		
Rated Torque (kg-m)	2.50		
Locked rotor current % FLC	600		
Starting torque % FLT	200		
Pull out torque % FLT	275		
Method of starting	Direct On Line		
Winding connections	Delta		
No of terminals	6		
Direction of rotation	Bidirectional		
Motor GD Sq. (kg-m ²)	0.03		
Load GD Sq. (kg-m ²)	0.03		
Starting time @100% V (Sec)	0.1		
Locked rotor Withstand time hot (Sec.)	8		
Locked rotor Withstand time cold (Sec.)	16		
Stator Thermal / Cooling time constant (min)	30 / 60		
Terminal box position	RHS From DE		
Cable size	1 * 3C,6-MM ²		
Bearing DE/ODE	6206-2Z-C3 / 6205-2Z-C3		
Type of lubrication	Sealed Bearing. No Lubrication Required		
Shaft Material	EN8 OR C40	Stator Body Material	Cast Iron
Net Weight (Approx.) kg	36		
Paint shade	RAL7034 Yellow grey		
Applicable standards	IS: 12615, IEC 60072,		
Accessories	, Not Applicable		
Customer specific requirement if any:	,As Per CGL Standard		
All performance data is subject to tolerance as per IS/IEC 60034			
			
Issued By :			
Date : 08/27/2024			

DIMENSION DRAWING OF 3 PH SQUIRREL CAGE TEFC INDUCTION MOTOR

PROJECTION



DO NOT SCALE

PLEASE ASK, IF IN DOUBT

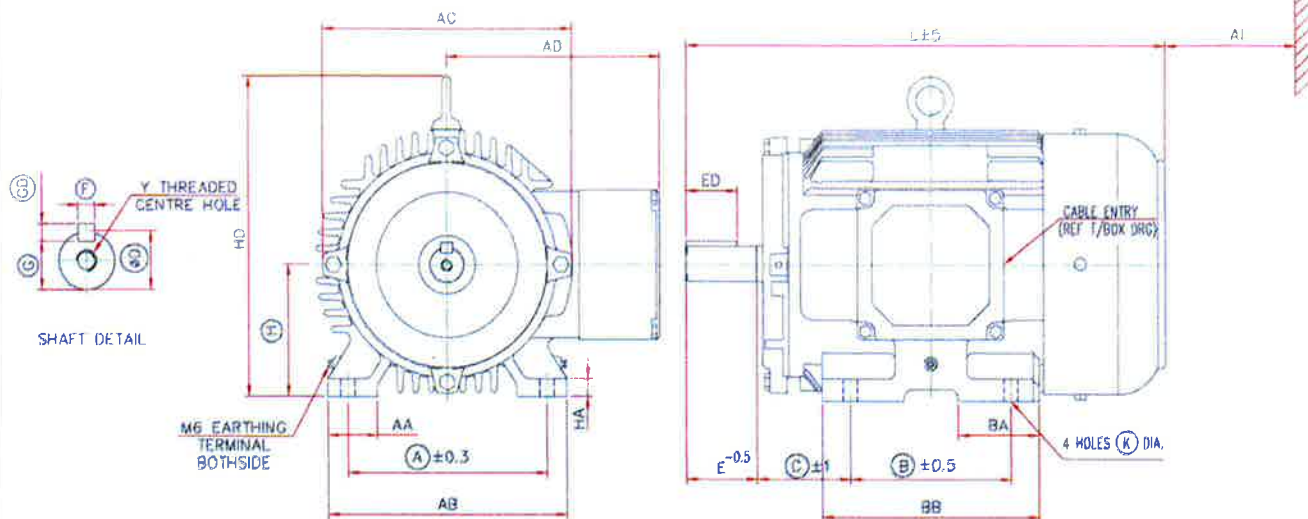

FRAME	FOOT FIXING										OVER ALL					MOTOR wt (kg)	AI**
	A	B	B1	C	H TOL	AA	AB	BA	BB	K TOL	AD	AC	L	HD	HA		
ND100L	160	140		63	100.0 / 99.7	36	192	51	170	12.0 / 12.5	200	205	380	250	16	36	60

D END SHAFT EXTENSION AND KEY						
D TOL	E	ED	F TOL	GD TOL	G	Y
28.009 / 27.996	60	44	8.00 / 7.96	7.0 / 6.9	24.0 / 23.8	M10X22

- NOTES**
- TERMINAL BOX CAN BE ROTATED IN 360 DEG @90 DEG.
 - ONE EARTHING TERMINAL IS PROVIDED INSIDE MAIN TERMINAL BOX.
 - MOTOR MAY HAVE ADDITIONAL FOOT HOLES FOR CUSTOMER/SITE FLEXIBILITY
 - **MINIMUM DISTANCE FOR EFFICIENT COOLING OF MOTOR TO BE MAINTAINED BY USER

ALL DIMENSIONS ARE IN mm

RINGED DIMENSIONS ARE AS PER IS:1231/IEC60072

CUSTOMER		RATED O/P kW		3.7	NO OF POLES		4	
P.O. NO.		SSC/PO/STK/852		FRAME	ND100L	MAIN CABLE SIZE		1*3C,6-MM ²
IND. NO.		NMCD220697/100		MOUNTING	B3 (HORIZONTAL FOOT)			
CLIENT				TAG NO.			
PROJECT				NAME		DATE		REMARKS
DRN		SBK		27-Aug-24		TITLE <b style="text-align: center;">DIMENSIONAL DRAWING		
CHD		SBK		27-Aug-24				
APPROVED		SSN		27-Aug-24				



CG Power and Industrial Solutions Limited
 LT Motors Division
 Ahmednagar

DRG NO	NMCD220697/100-ND100L
REV	0